



# Specifications

## Performance data

<b>Accuracy RSS<sup>1</sup> (at constant temp)</b>	±1.0% FS (standard); ±0.4% FS, ±0.25% FS (optional)
<b>Non-linearity, BFSL</b>	±0.96% FS (standard); ±0.38% FS, ±0.22% FS (optional)
<b>Hysteresis</b>	0.10% FS

## Thermal effects<sup>2</sup>

<b>Compensated range °F (°C)</b>	0 to +150 (-18 to +65)
<b>Zero shift %FS/100°F(50°C)</b>	±0.033 (±0.06)
<b>Span shift %FS/100°F(50°C)</b>	±0.033 (±0.06)

<b>Max. line pressure</b>	10 PSI
<b>Overpressure</b>	Up to 10 PSI (range dependent)
<b>Long term stability</b>	0.5% FS/YR

## Environmental data

<b>Operating temperature °F (°C)<sup>3</sup></b>	0 to +175 (-18 to +79)
<b>Storage temperature °F (°C)</b>	-65 to +250 (-54 to +121)

## Position effect<sup>4</sup>

Range	Zero offset (%FS/G)
0 to 1" W.C.	2.3
0 to 0.25" W.C.	1
0 to 0.5" W.C.	0.5
0 to 1.0" W.C.	0.3
0 to 2.5" W.C.	0.2
0 to 10" W.C.	0.15

<sup>1</sup> RSS of Non-Linearity, Hysteresis, and Non-Repeatability.  
<sup>2</sup> Units calibrated at nominal 70°F. Maximum thermal error computed from this datum.  
<sup>3</sup> Operating temperature limits of the electronics only. Pressure media temperatures may be considerably higher.  
<sup>4</sup> Unit is factory calibrated at 0g effect in the vertical position.  
<sup>5</sup> Calibrated into a 50K ohm load, operable into a 5000 ohm load or greater.  
<sup>6</sup> Zero output factory set to within ±50mV (±25 mV for optional accuracies).

## Physical description

<b>Case</b>	Fire-retardant glass filled polyester (UL 94 V-O Approved)
<b>Electrical Connection</b>	Screw terminal strip
<b>Mounting</b>	4 screw holes on removable zinc plated steel base (designed for 2.75" snap track)
<b>Pressure Fittings</b>	3/16" O.D. barbed brass for 1/4" push on tubing
<b>Zero and Span Adjustments</b>	Accessible on top of case
<b>Weight (approx.)</b>	10 Ounces

## Electrical data (voltage)

<b>Circuit</b>	3-Wire (Com, Out, Exc)
<b>Excitation/output<sup>5</sup></b>	9 to 30 VDC / 0 to 5 VDC <sup>6,7</sup>
<b>Output impedance</b>	100 ohms
<b>Bidirectional output at zero pressure</b>	2.5 VDC <sup>6,7</sup>

## Electrical data (current)

<b>Circuit</b>	2-wire
<b>Output<sup>8</sup></b>	4 to 20 mA <sup>9,10</sup>
<b>External load</b>	0 to 800 ohms
<b>Min. loop supply voltage (VDC)</b>	9 + 0.02 x (resistance of receiver plus line)
<b>Max. loop supply voltage (VDC)</b>	30 + 0.004 x (resistance of receiver plus line)
<b>Bidirectional output at zero pressure</b>	12 mA <sup>9,10</sup>

## Pressure media

Clean air or similar non-conducting gases.

<sup>7</sup> Span (Full Scale) output factory set to within ±50mV. (±25 mV for optional accuracies).  
<sup>8</sup> Calibrated at factory with a 24 VDC loop supply voltage and a 250 ohm load.  
<sup>9</sup> Zero output factory set to within ±0.16mA (±0.08 mA for optional accuracies).  
<sup>10</sup> Span (Full Scale) output factory set to within ±0.16mA (±0.08 mA for optional accuracies).

Specifications subject to change without notice.

## Ordering information

Example part number: 26412R5WD11T1C; Model 264, 0 to 2.5 in. W.C. Range, 4 to 20 mA Output, Terminal Strip Electrical Connection, and ±1% Accuracy.

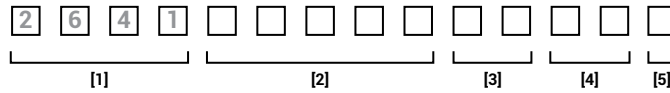

[1]	[2]	[2]	[3]	[4]	[5]
<b>Model</b>	<b>Unidirectional ranges</b>	<b>Bidirectional ranges</b>	<b>Output</b>	<b>Electrical termination</b>	<b>Accuracy<sup>1</sup></b>
<b>2641</b> Model 264	<b>0R1WB</b> 0 to 0.1" W.C. <b>R25WD</b> 0 to 0.25" W.C. <b>0R5WD</b> 0 to 0.5" W.C. <b>001WD</b> 0 to 1" W.C. <b>1R5WD</b> 0 to 1.5" W.C. <b>2R5WD</b> 0 to 2.5" W.C. <b>003WD</b> 0 to 3" W.C. <b>005WD</b> 0 to 5" W.C. <b>010WD</b> 0 to 10" W.C. <b>015WD</b> 0 to 15" W.C. <b>025WD</b> 0 to 25" W.C. <b>050WD</b> 0 to 50" W.C. <b>100WD</b> 0 to 100" W.C. <b>025LD</b> 0 to 25 Pa <b>050LD</b> 0 to 50 Pa <b>100LD</b> 0 to 100 Pa <b>250LD</b> 0 to 250 Pa <b>500LD</b> 0 to 500 Pa <b>10CLD</b> 0 to 1000 Pa	<b>R05WB</b> ±0.05" W.C. <b>0R1WB</b> ±0.1" W.C. <b>R25WB</b> ±0.25" W.C. <b>0R5WB</b> ±0.5" W.C. <b>001WB</b> ±1" W.C. <b>1R5WB</b> ±1.5" W.C. <b>2R5WB</b> ±2.5" W.C. <b>005WB</b> ±5" W.C. <b>7R5WB</b> ±7.5" W.C. <b>010WB</b> ±10" W.C. <b>025WB</b> ±25" W.C. <b>050WB</b> ±50" W.C. <b>025LB</b> ±25 Pa <b>050LB</b> ±50 Pa <b>100LB</b> ±100 Pa <b>250LB</b> ±250 Pa <b>500LB</b> ±500 Pa <b>10CLB</b> ±1000 Pa	<b>11</b> 4 to 20 mA <b>2D</b> 0 to 5 VDC	<b>T1</b> Terminal strip <b>A1</b> 1/2" conduit enc.	<b>C</b> ±1% FS <b>E</b> ±0.4% FS <b>F</b> ±0.25% FS <b>G</b> ±1% FS

<sup>1</sup> Optional accuracy codes E, F, G, include calibration certificate.

Contact Setra for versions not shown here.

## Dimensions

Electrical termination "T1"

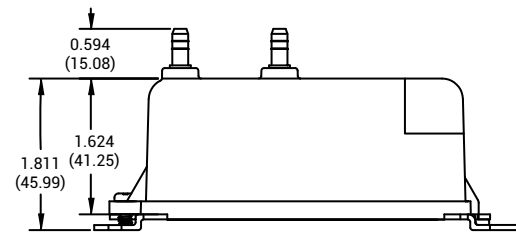
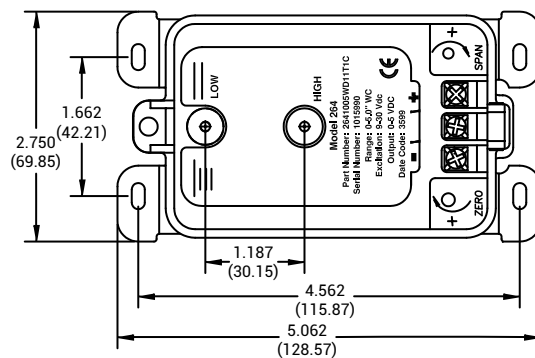

Electrical termination "A1"

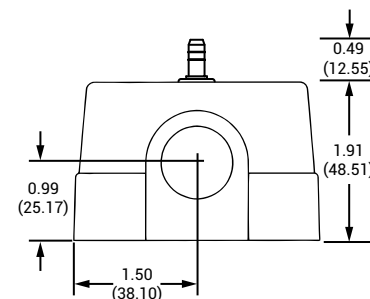
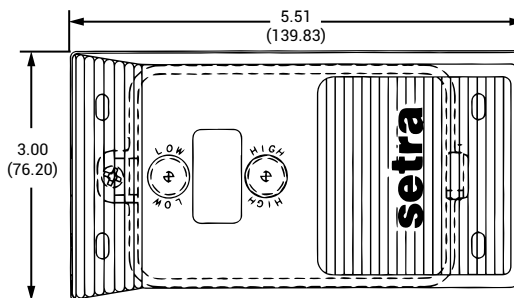

inches (mm)