



Type Overview

Type	DN	Rp [""]	Weight
P2P15PE-1GE	15	1/2	0.14 kg
P2P20PF-1GE	20	3/4	0.16 kg
P2P25PE-1GE	25	1	0.20 kg

Technical data

Materials	Used Materials
	Nickel-plated brass

Safety notes



- This accessory has been designed for use in stationary heating, ventilation and air-conditioning systems and must not be used outside the specified field of application, especially in aircraft or in any other airborne means of transport.
- Only authorised specialists may carry out installation. All applicable legal or institutional installation regulations must be complied during installation.
- The accessory may not be disposed of as household refuse. All locally valid regulations and requirements must be observed.

Dimensions

Dimensional drawings

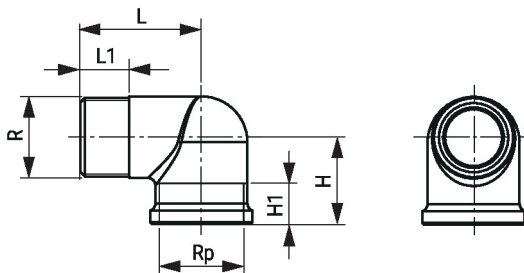

Type	DN	Rp [""]	R [""]	L [mm]	L1 [mm]	H [mm]	H1 [mm]	kg
P2P15PE-1GE	15	1/2	1/2	35	13	27	16.3	0.14
P2P20PF-1GE	20	3/4	3/4	39	14.5	31	16.3	0.16
P2P25PE-1GE	25	1	1	48	16.8	37.8	19.1	0.20