

STD100



PART NUMBERS

Part Number	Model Number	Probe mm (in)	NL mm (in)	Weight g (lb)	System
5123002010	STD100-50	50 (1.97)	63 (2.48)	113 (0.25)	Vista
5123004010	STD100-100	100 (3.94)	113 (4.45)	117 (0.26)	
5123006010	STD100-150	150 (5.9)	163 (6.42)	120 (0.26)	
5123008010	STD100-200	200 (7.87)	213 (8.39)	123 (0.27)	
5123010010	STD100-250	250 (9.84)	263 (10.35)	126 (0.28)	
5123012010	STD100-300	300 (11.81)	313 (12.32)	130 (0.29)	
5123014010	STD100-400	400 (15.75)	413 (16.26)	138 (0.30)	

SPECIFICATIONS

Sensor element . . . NTC, 1.8 k Ω at +25 °C (77 °F)
 Enclosure rating IP 65
 Dimensions . . . see table above and figure overleaf
 Accuracy see table

Time constants

Air velocity 1.5 m/s approx. 72 s
 Air velocity 3.0 m/s approx. 52 s

Materials

Immersion tube stainless steel
 Connection box polyamid plastic
 Mounting flange black plastic

Temperatures

Ambient min. -40 °C (-40 °F)
 max. 130 °C (266 °F)
 Operating min. -40 °C (-40 °F)
 max. 150 °C (302 °F)

Standards

EMC EN 50081-1, EN 50082-1

Duct Temperature Sensor NTC 1.8 k Ω for Vista

The STD100 temperature sensor is intended for air duct mounting. A plastic duct mounting bracket is supplied, with a securing screw.

The STD100 housing is equipped with a 20 mm cable fitting.

ACCURACY

At Temperature	Accuracy
-25 °C (-13 °F)	± 0.7 °C (± 1.3 °F)
± 0 °C (32 °F)	± 0.5 °C (± 0.9 °F)
25 °C (77 °F)	± 0.3 °C (± 0.5 °F)
50 °C (122 °F)	± 0.6 °C (± 1.1 °F)
75 °C (167 °F)	± 0.9 °C (± 1.6 °F)
100 °C (212 °F)	± 1.3 °C (± 2.3 °F)

DIMENSIONS (mm/in)

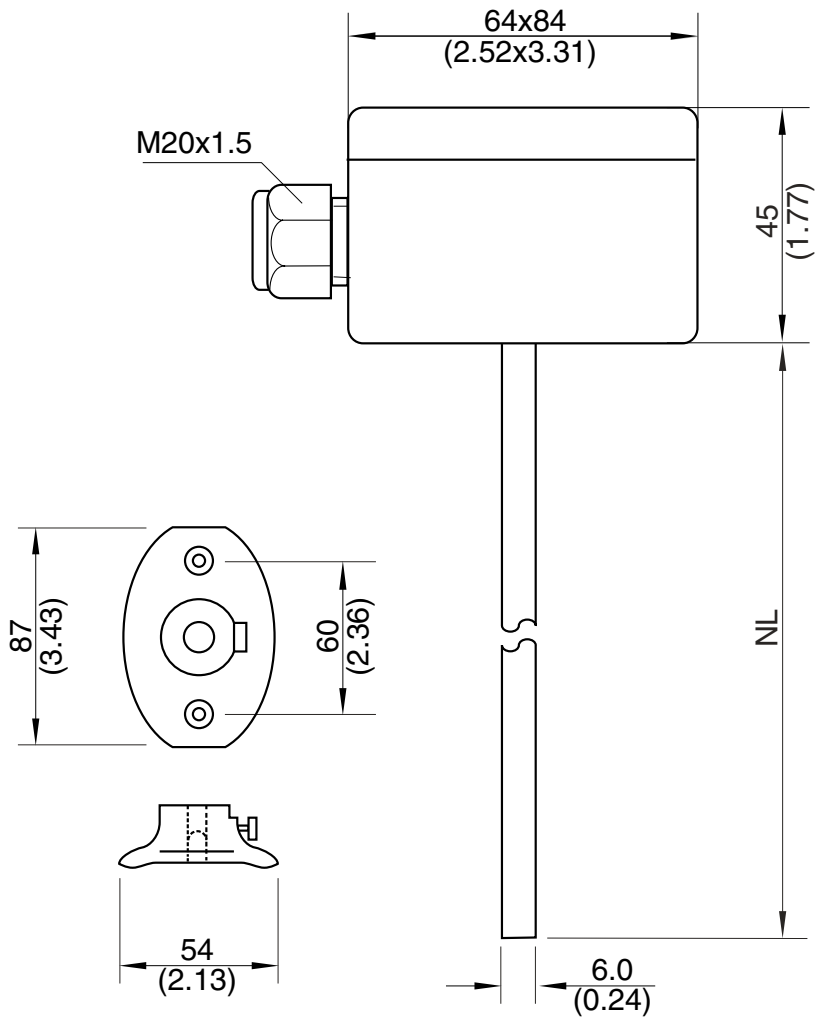

WIRING

